



Fitzwilliam Wentworth Estate

HERITAGE | LANDSCAPE | ECONOMY | COMMUNITY

Estate Office • Wentworth • Rotherham
South Yorkshire • S62 7TD
Telephone 01226 742041 • Fax 01226 350292
Email office@wentworthestate.co.uk
www.wentworthestate.co.uk

4 West Hall Fold Wentworth S62 7TJ

TO LET Unfurnished
Rent £1,925pcm

A spacious 4 bedroom semi-detached former farmhouse.

Location:

Located near the Old Church in Wentworth Village



The accommodation (see floor plan over):

Extending to approx. 2045sqft, the property comprises; on the ground floor, a spacious kitchen with decorative Rayburn, three reception rooms all with working solid fuel stove or fireplace and original features. Access to cellar and garage. On the first floor are four bedrooms, a family bathroom and a further w.c.

Outside:

The property has its own parking area and garage as well as access to shared parking for West Hall Fold. To the rear are private mature gardens, outdoor WC and excellent views over adjacent farmland towards Harley & Elsecar.

Services:

All mains services including gas combi central heating.

Term:

The property will be available on an Assured Shorthold Tenancy for an initial term of 12 months.

Rental:

Rental of £1,925pcm, payable monthly in advance by bank standing order. The Tenant will be fully responsible for all other outgoings on the property



Deposit:

A deposit of £2,221 will be payable prior to commencement of the Tenancy and will be returned on termination, subject to all commitments having been met by the Tenant.

Council Tax Band: E

Energy Efficiency Rating

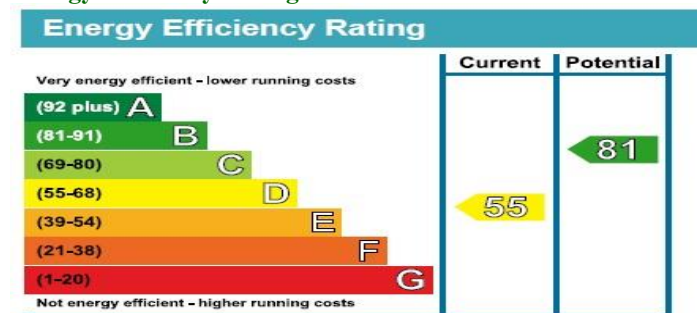

Applications and viewing:

If you are interested in this property, in the first instance, please complete the application form (downloadable from the property page), save and return via your own email to office@wentworthestate.co.uk. *Accompanied viewings will only be offered on receipt of a completed form.*

Note: Viewings are undertaken at your own risk. Vacant property can be hazardous. Beware of slip/trip hazards, naked wires, sharp surfaces and poorly lit spaces etc. Do not interfere with plumbing or wiring installations etc. Children are to be under the charge of accompanying adults and must be supervised at all times.

Particulars prepared August 2025

Ref: AT 615

Photographs, Tenancy and Floor Plans

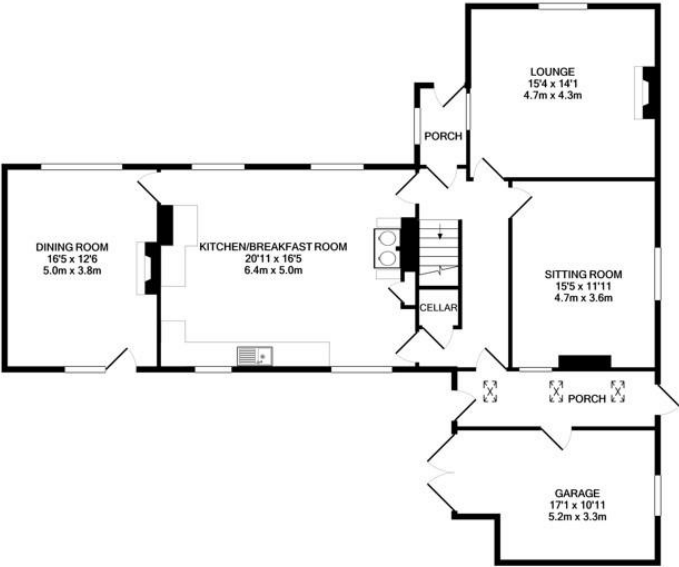

Fitzwilliam Wentworth Estate

HERITAGE | LANDSCAPE | ECONOMY | COMMUNITY



Fitzwilliam Wentworth Estate
HERITAGE | LANDSCAPE | ECONOMY | COMMUNITY