



Fitzwilliam Wentworth Estate

HERITAGE | LANDSCAPE | ECONOMY | COMMUNITY

Estate Office • Wentworth • Rotherham
South Yorkshire • S62 7TD
Telephone 01226 742041 • Fax 01226 350292
Email office@wentwortheastate.co.uk
www.wentwortheastate.co.uk

LAND TO LET

Available Immediately

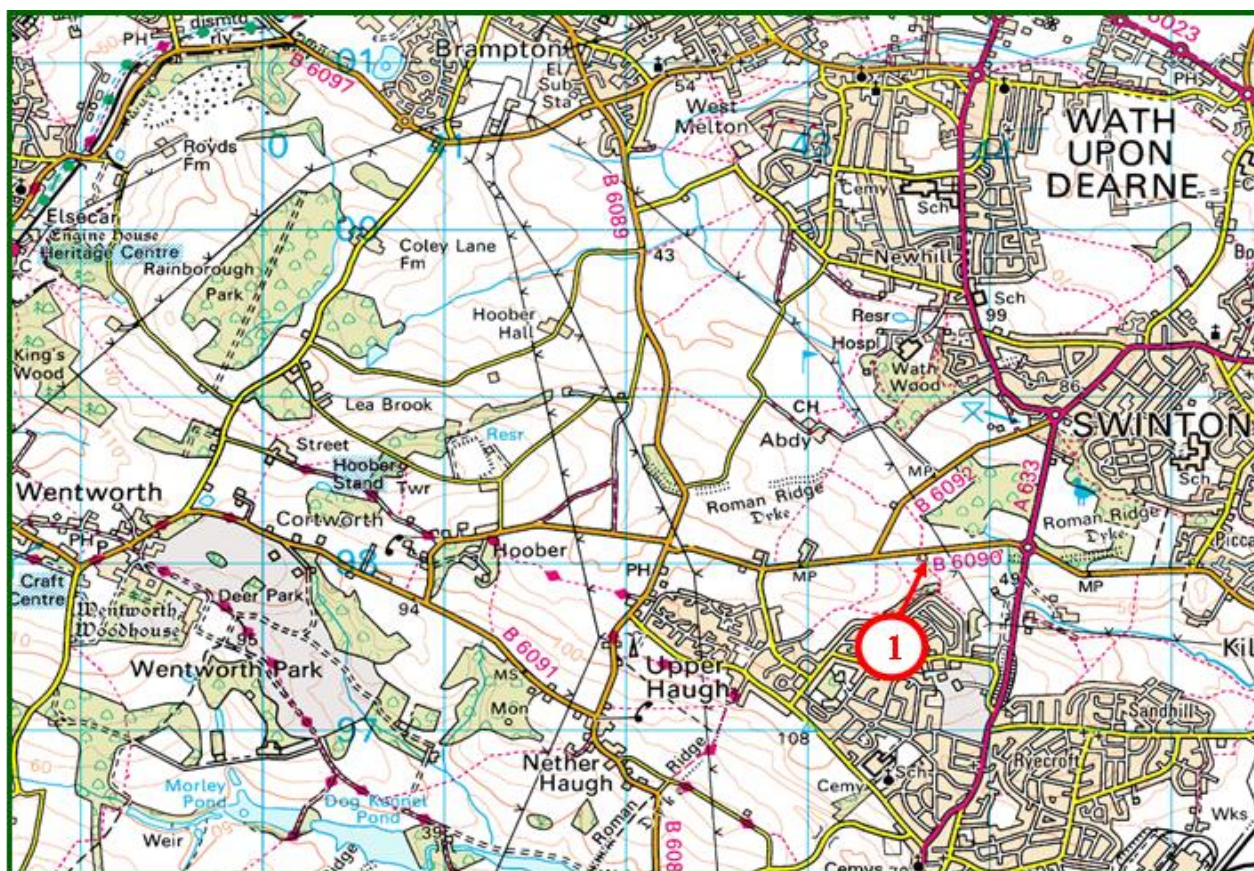

Terms:

The land will be let on the Estates standard grazing agreement on the following terms:

- Rent due monthly in advance.
- Rent reviews at 3 yearly intervals
- Sub-letting is strictly prohibited.
- Tenant to be responsible for maintenance of fences. Landlord will arrange for annual cutting of hedges where required.
- A draft agreement is available for inspection on request.

Viewing:

Interested parties view at their own risk in reasonable daylight hours.

Reservations:

All sporting and mineral rights.

Offers:

Applicants should complete the attached form (page 3), to be returned to the Estate Office no later than Friday 8th March.

The Fitzwilliam Wentworth Estate gives notice (i) The particulars are set out as a brief outline only to indicate availability and do not constitute, nor constitute part of, an offer or contract. (ii) All descriptions, dimensions, references to condition and necessary permissions for use and occupation and other details are given without responsibility. Any intending tenants should not rely on them as statements or representations of fact but must satisfy themselves by inspection or otherwise as to the correctness of each of them. (iii) No person in the employment of the Fitzwilliam Wentworth Estate has any authority to make or give any representation or warranty in relation to this property.

Lot 1:

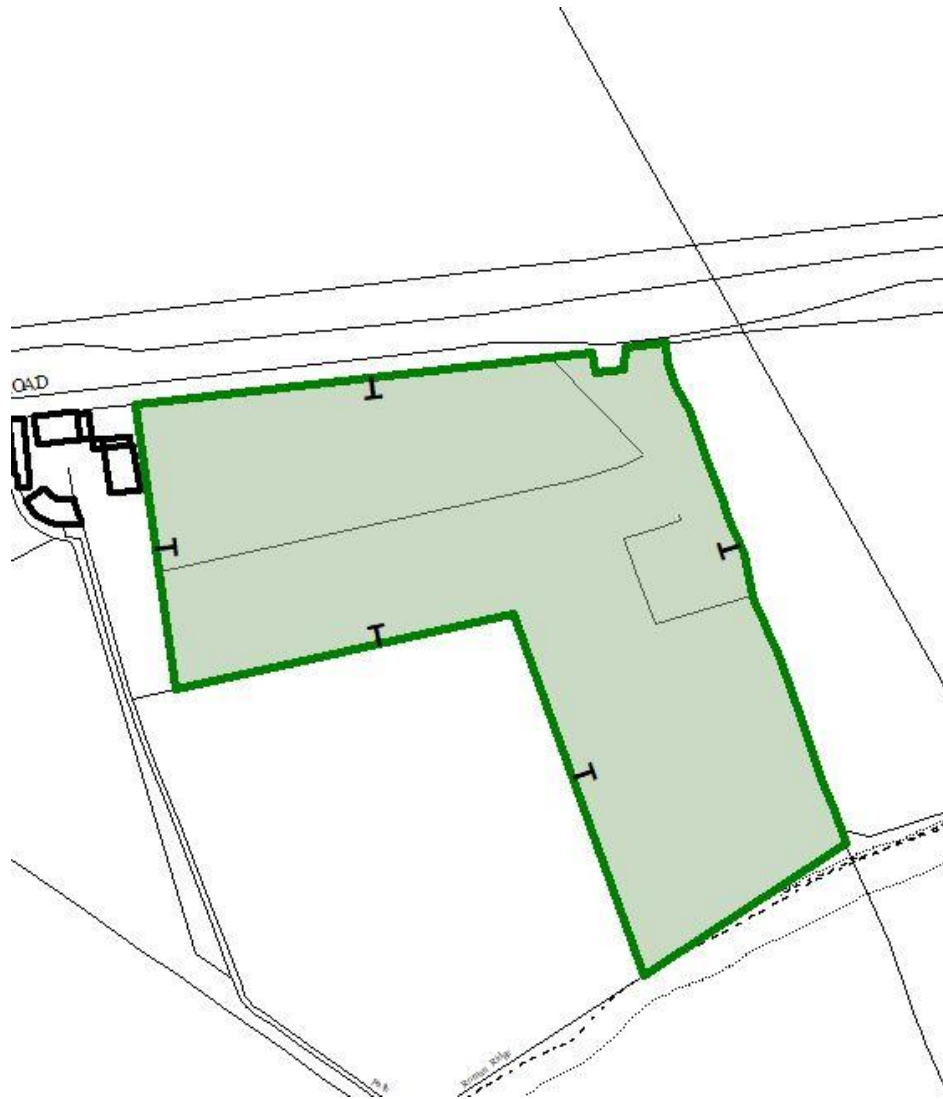

- 2.18 acres, or thereabouts, located at Wentworth Road, Rawmarsh.
- Guide rent £130pcm.
- The number of horses to be grazed is restricted to 2 horses/ponies.
- To apply please complete the application form below.
- A post and rail fence will be put up on the roadside boundary before the start of the tenancy.

Offer Form

This form should reach the Fitzwilliam Wentworth Estates at Estate Office, Clayfield Lane, Wentworth, Rotherham S62 7TD (email: admin@wentwortheastate.co.uk).

To: Fitzwilliam Wentworth Estates

Having read the particulars and inspected the land I offer to take the following parcel of land at the following rent:

✓
☐ Lot 1: £_____

Full Name: _____

Address: _____

Tel No's: _____

Email: _____

Signed: _____ **Date** _____

Please give details below including:

- Details of previous landlords of grazing land.
- Details of proposed use of the land (must include the number and nature of animals to be grazed).
- Any special/peculiar provisions.

(continue on a separate page if necessary)

The Landlords do not bind themselves to accept the highest or any offer.