



Fitzwilliam Wentworth Estate

HERITAGE | LANDSCAPE | ECONOMY | COMMUNITY

Estate Office • Wentworth • Rotherham
South Yorkshire • S62 7TD
Telephone 01226 742041 • Fax 01226 350292
Email office@wentwortheestate.co.uk
www.wentwortheestate.co.uk

75 Main Street Wentworth S62 7TN

TO LET Unfurnished
Rent £750pcm

Central Village End Terraced Cottage

Location:

The cottage is located set back from the road near the George & Dragon Inn in the village of Wentworth.

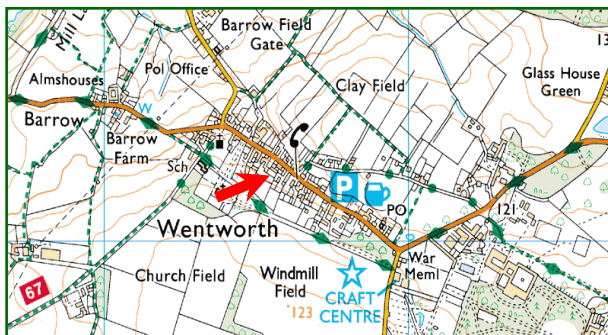

The accommodation (see floor plan over).

Total floor area approx. 840 sq. ft., the property comprises a living room, kitchen and pantry on the ground floor. On the first floor is a family bathroom and 1 double and 1 single bedroom. A further staircase leads to another double bedroom on the second floor.

Outside:

A small front garden and a private garden to the side with storage shed. Shared parking may be available.

Services:

All mains services including gas combi central heating.

Council Tax Banding: C

Term

The property will be available on an Assured Shorthold Tenancy for an initial term of 12 months.

Rental

Rental of £750 per calendar month payable monthly in advance by bank standing order. The Tenant will be fully responsible for all other outgoings on the property.



Deposit

A deposit of one month's rent will be payable prior to commencement of the Tenancy and will be returned on termination, subject to all commitments having been met by the Tenant.

Energy Efficiency Rating

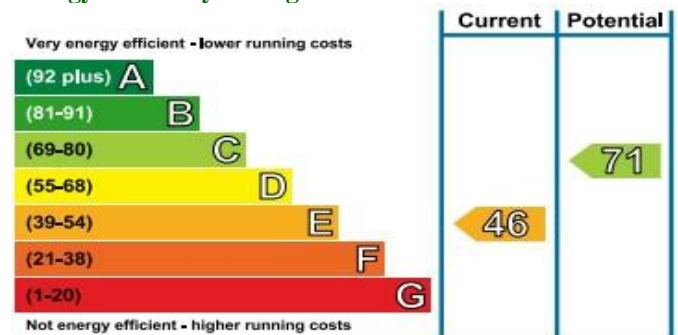

To view:

Due to covid-19 restrictions our normal letting routine has been amended to meet government guidance. If you are interested in this property, in the first instance, please complete the revised application form (downloadable from the property page) and return to office@wentwortheestate.co.uk

Note: Viewings are undertaken at your own risk. Vacant property can be hazardous. Beware of slip/trip hazards, naked wires, sharp surfaces and poorly lit spaces etc. Do not interfere with plumbing or wiring installations etc. Children are to be under the charge of accompanying adults and must be supervised at all times.

Particulars prepared: July 2021 Ref: AT 562

Page 1 of 2

Photographs, Tenancy & Floor Plans

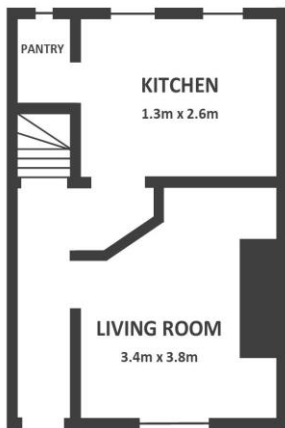
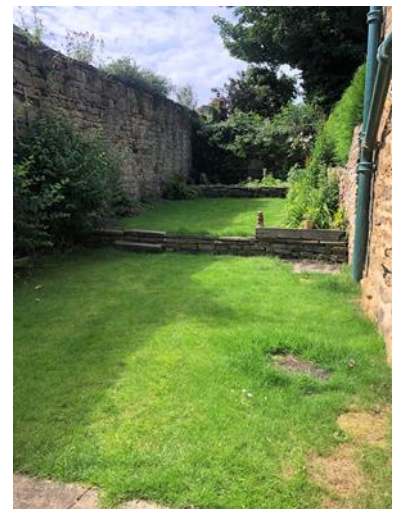

Ground Floor

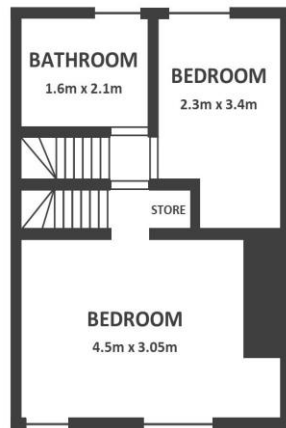

First Floor

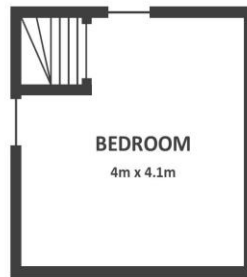

Second Floor

