



Fitzwilliam Wentworth Estate

HERITAGE | LANDSCAPE | ECONOMY | COMMUNITY

Estate Office • Wentworth • Rotherham
South Yorkshire • S62 7TD
Telephone 01226 742041 • Fax 01226 350292
Email office@wentworthestate.co.uk
www.wentworthestate.co.uk

Peppermint Cottage Cortworth Lane Wentworth S62 7SB

TO LET Unfurnished
Guide Rent £750pcm

A fully refurbished two bedroom detached cottage on the outskirts of Wentworth Deer Park

Location:

The cottage is located on Cortworth Lane (B6090), between Wentworth village and Nether Haugh.

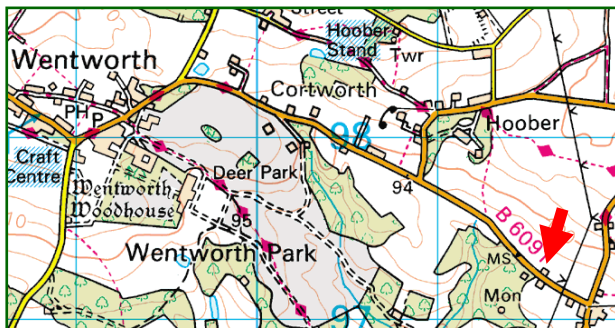

The accommodation (see floor plan over):

Approximately 830sqft (77sq m) comprising: 2 reception rooms, kitchen, ground floor bathroom and 2 bedrooms.

Outside:-

Large (½ acre) garden with stick shed/coal store.
Off road parking.

Services:

Mains electric and water. Oil-fired C-heating. Septic tank.

Council Tax Banding: Band D.

Term

The property will be available on an Assured Shorthold Tenancy for an initial term of 12 months.

Rental

Offers of rental are invited in the region of £750 per calendar month payable monthly in advance by bank standing order.

The Tenant will be fully responsible for all other outgoings on the property.



Deposit

A deposit of one month's rent will be payable prior to commencement of the Tenancy and will be returned on termination, subject to all commitments having been met by the Tenant.

Energy Efficiency Rating

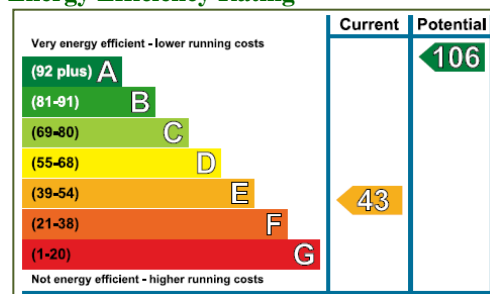

To view:

Contact Miss Rachel Towers at the Estate Office on 01226 742041 or press enquire via webpage, providing your contact details.

Note: Viewings are undertaken at your own risk. Vacant property can be hazardous. Beware of slip/trip hazards, naked wires, sharp surfaces and poorly lit spaces etc. Do not interfere with plumbing or wiring installations etc. Children are to be under the charge of accompanying adults and must be supervised at all times.

Particulars prepared: December 2018 Ref: ME 537

Page 1 of 2

Tenancy & Floor Plans

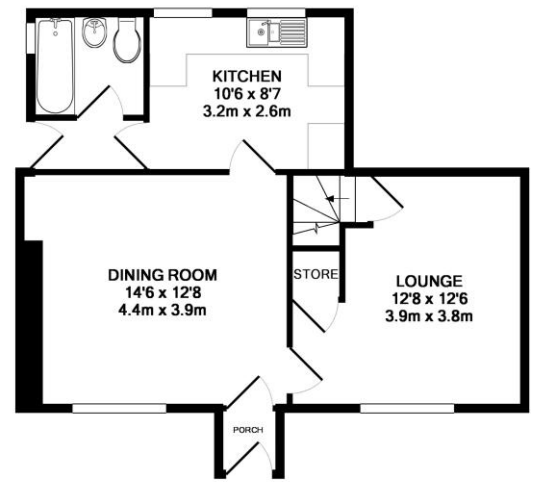

GROUND FLOOR

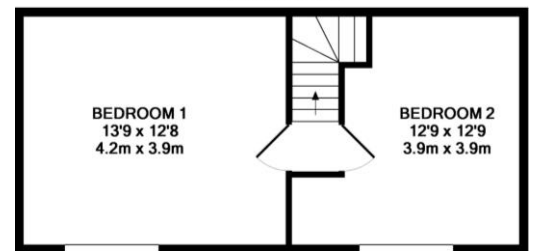

1ST FLOOR

Photographs

